

Our School.

The present school which was called Anahilt Public Elementary School was built in 1939 for the Down County Education Authority. This school which was designed by Mr. J. S. Munce was built by Mr. R. Murray of Belfast and opened on 27th July, 1939. by Mrs. Duncan B.A.

After the opening ceremony Miss Elsie Brown, a senior pupil, presented Mrs. Duncan with a bouquet. Other members of the platform party were Rev. H. Mc Kinty and Major Workman. The opening address was given by Major Workman, and the Rev. J. Mc Cracken read a portion of scripture. The Rev. H. Mc Kinty offered prayer and Mrs. Duncan addressed the Company and declared the New School open. Mr. Munce, the architect, presented a souvenir of the occasion to Mrs. Duncan. Mr. J. A. Cole, Senior Chief Inspector of the Ministry of Education gave a short speech. A vote of thanks to Mrs. Duncan was proposed by Rev. J. Mc Cracken and was seconded by Rev. T. J. K. Rankin. The ceremony ended with the National Anthem.

The platform party and guests, inspected the building and were later entertained to tea by the Local Management Committee.

When the new school was opened 58 children attended it. In those days the teaching staff were Mr. J. B.

Cochrane, the Principal, and Miss M.A. Reid the assistant.

Later in 1951 the numbers increased and a temporary classroom was added and a third member of staff, Mr Nelson was appointed.

In 1957 the school was reorganized and the 11 + boys transferred to Lisnagarvey Intermediate followed in 1958 by the 11 + girls going to Fort Hill Intermediate.

In 1968/9 our school was modernised and enlarged. Each classroom being self-contained i.e. having its own cloakroom, toilets and wash hand basins e.t.c. A dining room was also added where meals which come in containers from the Central Kitchen in Dromara are consumed.

In Sept. 1970 Clintogh and Burren P. Schools closed and most of the children were accommodated in Anahilt. Three years later in 1973 Drumlough P. School closed and the children also transferred to Anahilt. The enrolment then increasing to 165 approx. and to cope with the additional numbers 3 mobile classrooms had to be erected.

Over 100 children in our school travel by our school bus driven by Mr. G. Maquire, but sad to say I do not live in the bus route.

Our present teaching staff now consists of Principal:- Mr. W. G. Kyle, V. Principal:- Miss Reid, assistants:- Mrs. Eddi

Mrs. Erwin, Mrs. Crawford, Mrs. Polly
and Mrs. Rogers.

By Sheena Carson. P.7.3

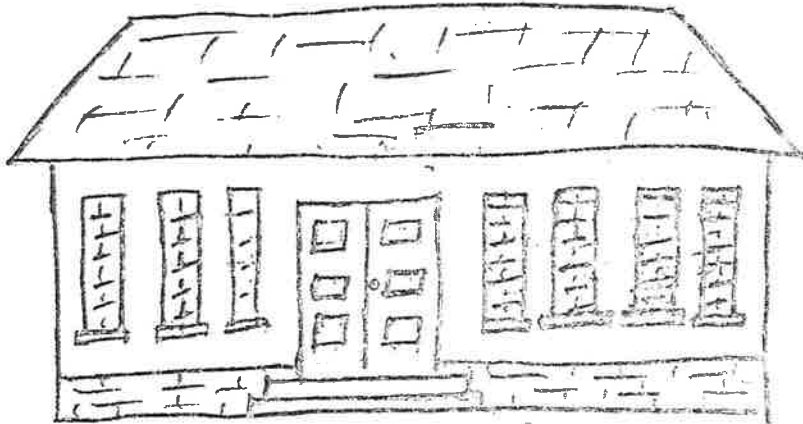

By
Will Jordan

Our new School.

Our new school has now been planned and it is hoped that work will commence in the autumn of this year and last for about 18 months. After alterations the present school building will be the new assembly/dining room and kitchen.

Meals will be cooked in the school kitchen instead of coming in containers from the Central Kitchen in Dromera.

Five new classrooms and a T/V room will also be added. While the new school is being built we will be accommodated in a temporary school a short distance away.

by Ruth Rogers. P.4.